

ТЕШИ.66591.01.000 СБ

ТЕШИ.66591.01.000



Схема электрическая	Обмотка	N ВЫВОДОВ	Кол. витков	Провод	Изоляция	Выводы		Трубка термостойкая 8/2
						Выводы марка	Выводы длина	
	W1-1	1-3	190	ПЭТВ-2 0,9	Поверх обмоток Бумага К-170 в 2 слоя	ПЭТВ 2,5 мм	200	
	W1-2	2-4	190					
	W2-1	5-6	8	ПЭТВ-155 3,15	Поверх обмоток Полиэстеровая огнестойкая лента ГТК ГY-100			
	W2-2	6-7	14					
	W2-3	7-8	7					
	W3-1	9-10	2					
	W3-2	10-11	1					

ТЕШИ.66591.01.000 СБ

1. Размеры для справок.
2. Катодку пропитать лаком БТ987.
3. Остальные ТТ по СТБ 1022.

Катушка

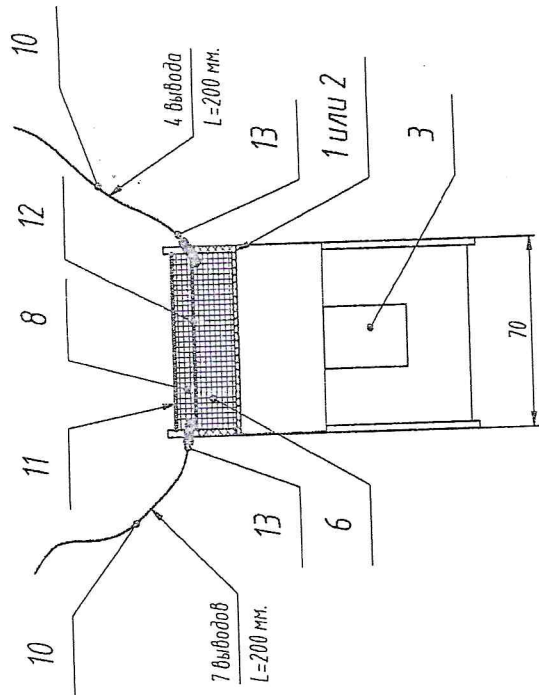
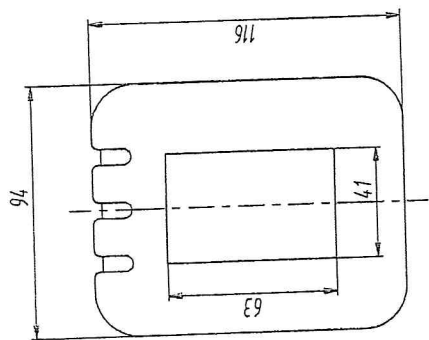
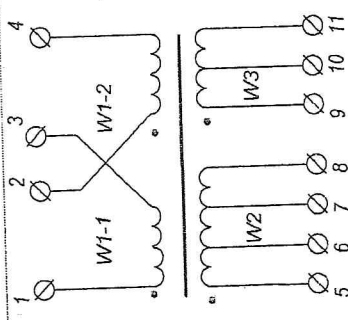
Сборочный чертеж

Изм.	Лист	№ докум.	Подп.	Дата	Лист	Масса	Масштаб
Разраб.	Караян	08.01.24				3,8 кг	1:1
Пров.	Давидюк						
Т. контр.	Гендель						
Н. контр.	Рослова						

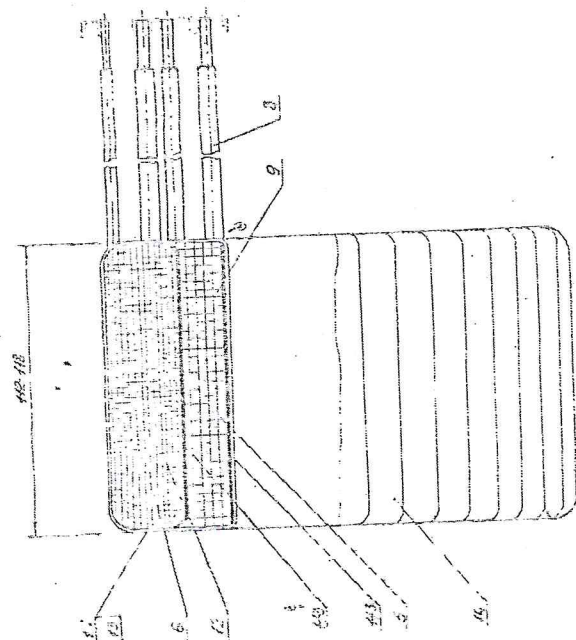

Вопросы.

[illegible]

В ПОСЛЕДНІЙ
 В ПОСЛЕДНІЙ
 В ПОСЛЕДНІЙ

5781-18 C5

Case No.	Case Name	Case Type	Case Status	Case Date	Case Time	Case Location	Case Description	Case Notes	Case Remarks
10001	John Doe	Case 1	Open	2023-10-26	10:00	Room 101	John Doe is a patient of the hospital.	John Doe is a patient of the hospital.	John Doe is a patient of the hospital.
10002	Jane Smith	Case 2	Open	2023-10-26	11:00	Room 102	Jane Smith is a patient of the hospital.	Jane Smith is a patient of the hospital.	Jane Smith is a patient of the hospital.
10003	Bob Johnson	Case 3	Open	2023-10-26	12:00	Room 103	Bob Johnson is a patient of the hospital.	Bob Johnson is a patient of the hospital.	Bob Johnson is a patient of the hospital.
10004	Alice Brown	Case 4	Open	2023-10-26	13:00	Room 104	Alice Brown is a patient of the hospital.	Alice Brown is a patient of the hospital.	Alice Brown is a patient of the hospital.
10005	Charlie Davis	Case 5	Open	2023-10-26	14:00	Room 105	Charlie Davis is a patient of the hospital.	Charlie Davis is a patient of the hospital.	Charlie Davis is a patient of the hospital.
10006	Diana Evans	Case 6	Open	2023-10-26	15:00	Room 106	Diana Evans is a patient of the hospital.	Diana Evans is a patient of the hospital.	Diana Evans is a patient of the hospital.
10007	Frank Green	Case 7	Open	2023-10-26	16:00	Room 107	Frank Green is a patient of the hospital.	Frank Green is a patient of the hospital.	Frank Green is a patient of the hospital.
10008	Grace Hill	Case 8	Open	2023-10-26	17:00	Room 108	Grace Hill is a patient of the hospital.	Grace Hill is a patient of the hospital.	Grace Hill is a patient of the hospital.
10009	Henry King	Case 9	Open	2023-10-26	18:00	Room 109	Henry King is a patient of the hospital.	Henry King is a patient of the hospital.	Henry King is a patient of the hospital.
10010	Ivy Lee	Case 10	Open	2023-10-26	19:00	Room 110	Ivy Lee is a patient of the hospital.	Ivy Lee is a patient of the hospital.	Ivy Lee is a patient of the hospital.
10011	Jack Miller	Case 11	Open	2023-10-26	20:00	Room 111	Jack Miller is a patient of the hospital.	Jack Miller is a patient of the hospital.	Jack Miller is a patient of the hospital.
10012	Karen Wilson	Case 12	Open	2023-10-26	21:00	Room 112	Karen Wilson is a patient of the hospital.	Karen Wilson is a patient of the hospital.	Karen Wilson is a patient of the hospital.
10013	Leo White	Case 13	Open	2023-10-26	22:00	Room 113	Leo White is a patient of the hospital.	Leo White is a patient of the hospital.	Leo White is a patient of the hospital.
10014	Mia Young	Case 14	Open	2023-10-26	23:00	Room 114	Mia Young is a patient of the hospital.	Mia Young is a patient of the hospital.	Mia Young is a patient of the hospital.
10015	Noah Adams	Case 15	Open	2023-10-26	00:00	Room 115	Noah Adams is a patient of the hospital.	Noah Adams is a patient of the hospital.	Noah Adams is a patient of the hospital.
10016	Olivia Baker	Case 16	Open	2023-10-26	01:00	Room 116	Olivia Baker is a patient of the hospital.	Olivia Baker is a patient of the hospital.	Olivia Baker is a patient of the hospital.
10017	Peter Clark	Case 17	Open	2023-10-26	02:00	Room 117	Peter Clark is a patient of the hospital.	Peter Clark is a patient of the hospital.	Peter Clark is a patient of the hospital.
10018	Quinn Hall	Case 18	Open	2023-10-26	03:00	Room 118	Quinn Hall is a patient of the hospital.	Quinn Hall is a patient of the hospital.	Quinn Hall is a patient of the hospital.
10019	Rachel King	Case 19	Open	2023-10-26	04:00	Room 119	Rachel King is a patient of the hospital.	Rachel King is a patient of the hospital.	Rachel King is a patient of the hospital.
10020	Samuel Lee	Case 20	Open	2023-10-26	05:00	Room 120	Samuel Lee is a patient of the hospital.	Samuel Lee is a patient of the hospital.	Samuel Lee is a patient of the hospital.

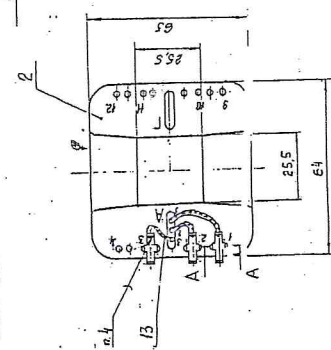

Puc. 1

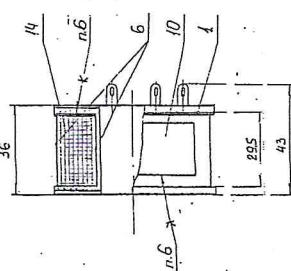

Puc. 2

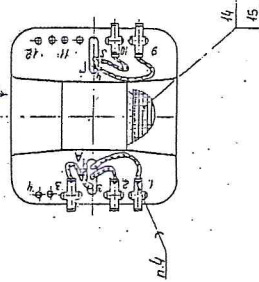

Детальное см. Рис. 1.

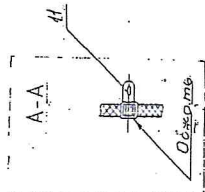

1. Размеры для справок.
2. Катанушку пропитать лаком БТ-987 ГОСТ 6244-70 по технологическому инструкции №2418.25001.05.06-82.
3. Мелестик поз. И. и онто кардаса от покрытла лаком предохранителе.
4. Припой ЛРЗ ПОС-61 ГОСТ 2493-76.
5. Места пайки монтажные провода к правому обмотке изолировать Карнаком из трех слоев бумаги лз. б. клеей Б99-2 ГОСТ 14174-74.
6. Муфта на входе разбора усилительного
7. На чертеже не показана
8. Показаны ТП д. ртм з. ушл ос. 2-44.

[illegible]

36162-12-0055	Катушка сборочных медных	А	0429 11	ИИЖА
36162-12-0055	Катушка сборочных медных	А	0429 11	ИИЖА

ТЕШИ.66606.10.000

1 2

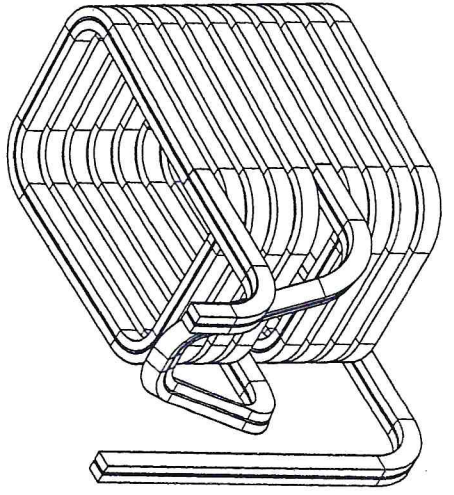
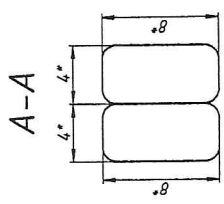
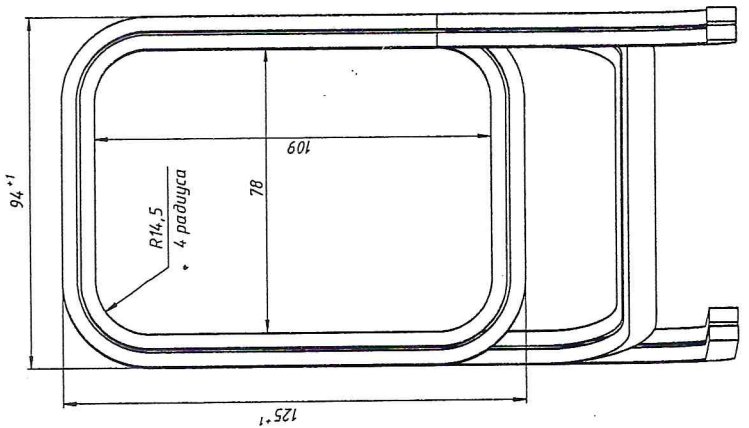
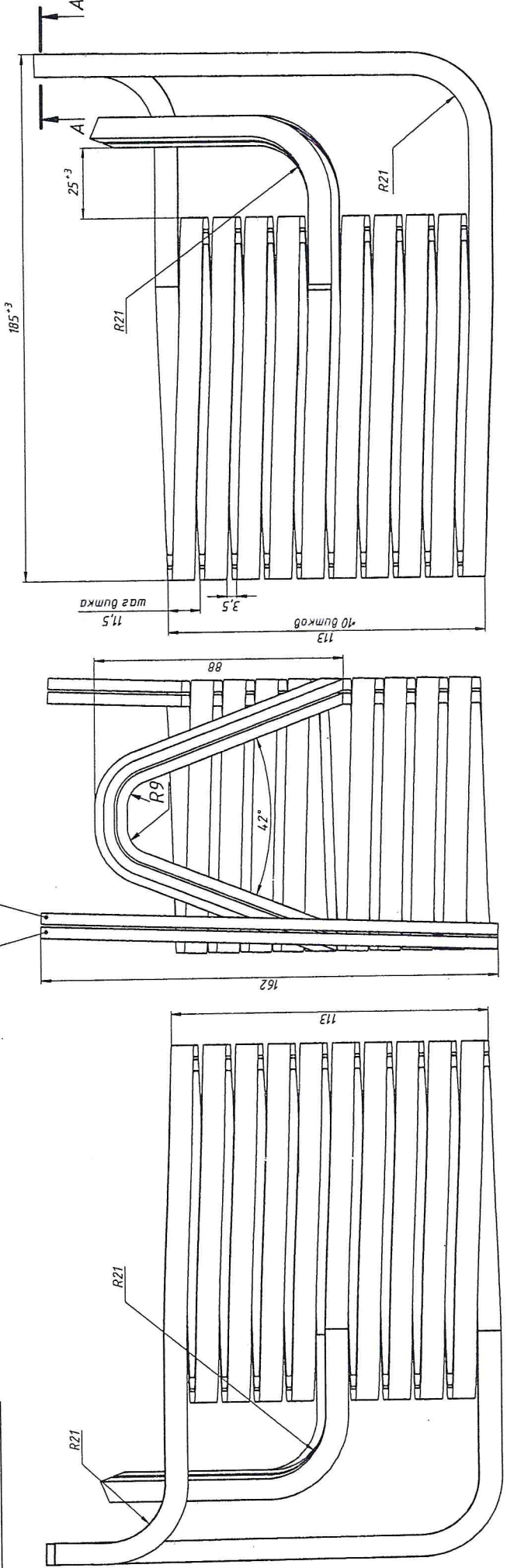

- 1. *Размеры для справок.
- 2. ГОСТ 30893.1- с. СТБ 1014.
- 3. Остальные ТТ по СТБ 1014.

ТЕШИ.66606.10.000				Лист	Масса	Масштаб
Шина				0	2,4 кг	1:1
Оборонный чертеж				Лист	Листов	1
Изм.	Лист	Не докум.	Подп.	Дата		
Разраб.	Садурский	Прош.	Никитин	Кажис		
Т. контр.	Гендель	И. контр.	Рослова	Уте.		